

Y.CT Precision

High resolution cone-beam computed tomography (CT) inspection system for small to medium-sized parts

Discover the difference in accuracy

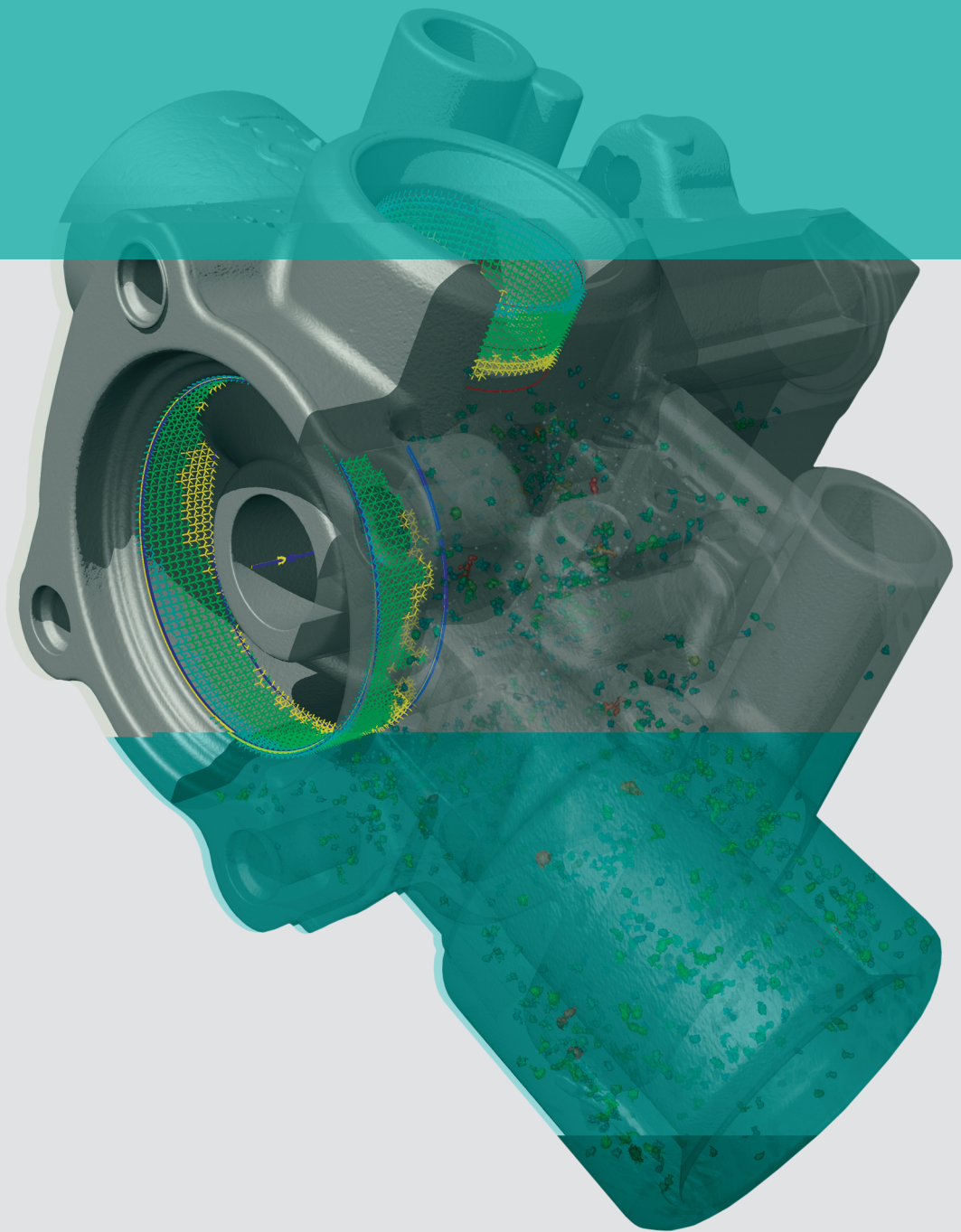

Explore the art of detection

As a world leader in non-destructive X-ray testing YXLON has mastered the art of detection. Based on our long experience in designing tailor-made X-ray and CT solutions, we help our customers achieve excellent results during their scientific research and development projects as well as production inspection procedures. Making the invisible visible – that's what we call the art of detection.

No matter what industry you're in, we provide you with reliable 3D components analyses and accurate dimensional measurements. Are you doing research in the field of geology, archeology or material science and engineering? Do you need to inspect cultural artifacts? YXLON's computed tomography

(CT) excellence also supports you in your scientific and art-related testing.

Because YXLON CT solutions are tried and tested premium systems, they blend smoothly into your processes, guaranteeing a fast workflow and high uptime. Our CT product range equips you with relevant information regarding the interior and exterior structures of your items in one data set. This way, you reduce your inspection time, allowing you to concentrate on your core business.

Additionally, the worldwide YXLON service network is an important factor to be taken into account when evaluating the YXLON CT price-performance ratio – one that appeals to quality managers, operations personnel, and purchasers alike.

Where do you use YXLON CT systems?

- Analysis of porosities and inclusions
- Dimensional measurement
- Analysis of composite materials (carbon / glass fiber reinforced plastic)
- Assembly or structural analysis
- Wall thickness measurements
- Nominal / actual comparison
- Examination of historical art and archeological objects
- Investigation of geological samples

Glass fiber sample



Perform 3D inspections with premium detail recognition

Do you want to test small to medium-sized parts or large ones with lower density? Does a broad range of applications for research, development and quality assurance appeal to you? Choose the Y.CT Precision for maximum detail detection.

The new laminography technique precisely displays details which can't be distinguished in a 2D industrial X-ray image. Laminography can broaden your application range, i.e. you can easily X-ray non-rotatable large, flat parts like car doors and circuit boards – making laminography a perfect complement to regular CT.

The helical CT scan is another benefit that improves your testing procedures. By simultaneously rotating and moving the part vertically it eliminates the need for image stitching and provides supreme accuracy in all areas of tall parts.

Y.CT Precision has more to offer to maintain excellent images allowing you to detect porosities and inclusions: YXOLON's software tool box automatically reduces ring artifacts in your CT scans right at the source. You can also use various state-of-the-art reconstruction algorithms. Plus, the detector calibration process helps ensure consistent image quality.

Y.CT Precision key benefits

- Laminography to easily inspect large, flat parts like car doors
- Helical CT to avoid stitching and create homogenous images
- Intelligent image enhancement tool box for increased detail visibility
- Multiple parts tested in one inspection run to boost workflow

Detect what matters

The Y.CT Precision's microfocus tube allows superior detail recognition up to $4\ \mu\text{m}$ – the perfect basis for reliable inspections in your facility.

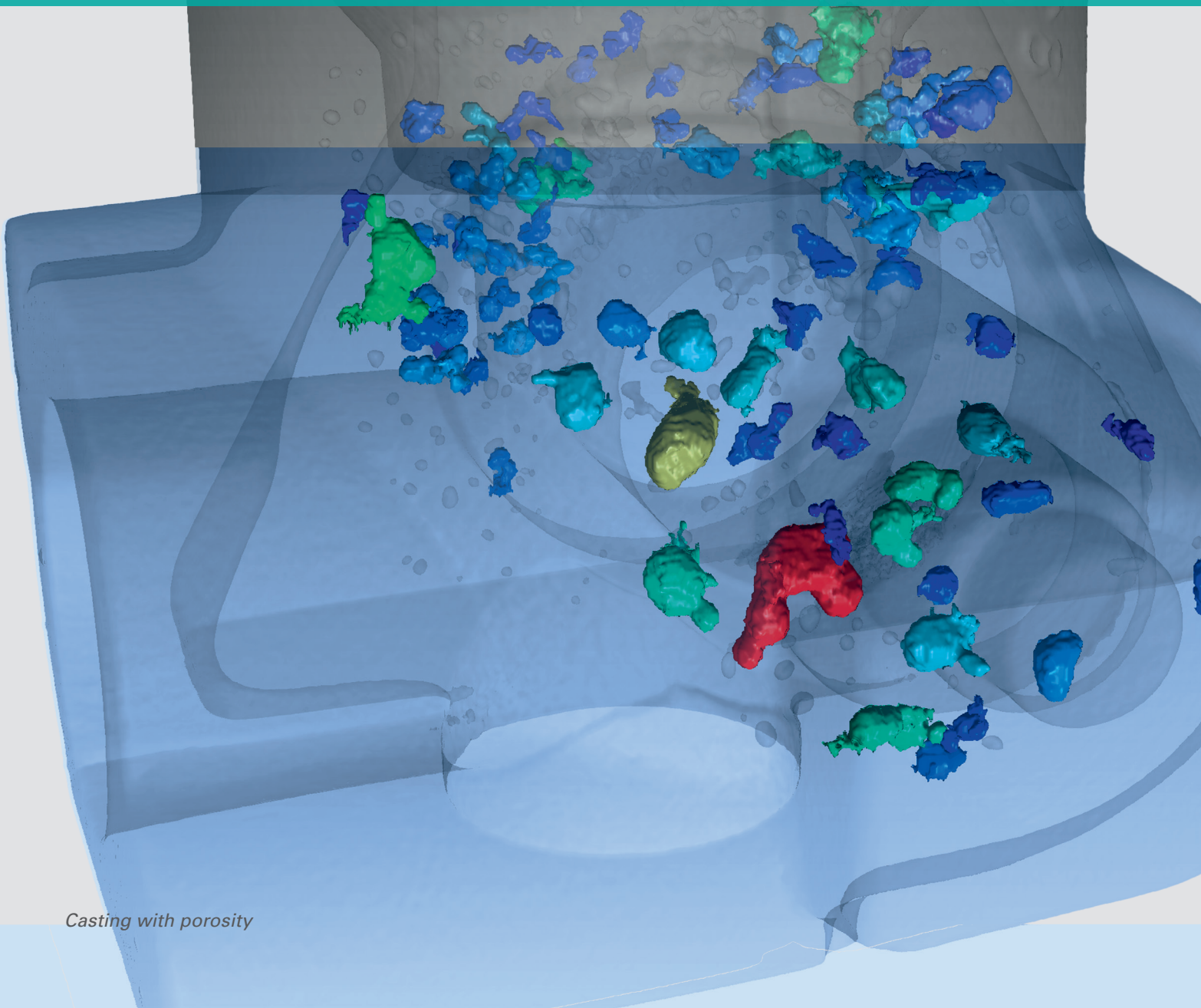

Casting with porosity

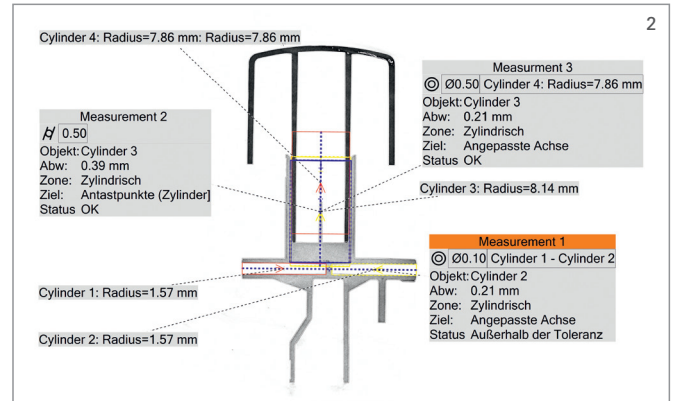
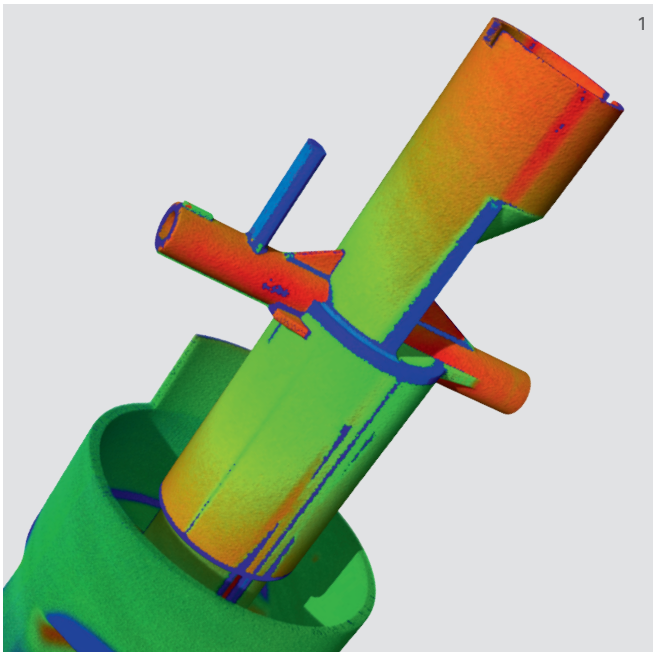

1 Plastic injection molding

2 Dimensional measurement

Experience exact repeatability

Y.CT Precision is built to find the details assuring excellent inspection results. It has the capability for very strong magnification to create highly detailed images. The rock solid granite manipulator makes your system very precise, durable, warp-resistant and temperature-independent. Benefit also from the microfocus X-ray tube with its unlimited lifespan thanks to a replaceable filament and targets.

In terms of imaging, the system boasts a flat-panel detector specifically selected for your application requirements. Each detector contains YXLON's exclusive performance specifications to ensure a high quality standard.

Count on smooth workflow made possible by the multiple parts testing functionality where one test run can cover more than one item. Smart software solutions also enhance the inspection process. Automated center determination, beam hardening correction, and a vertical and horizontal field-of-view extension help provide full-scale volume within a few minutes.

Which items and materials are especially suitable for Y.CT Precision?

- Fiber-reinforced composites
- Plastic injection molded parts
- Mechatronic modules
- Small aluminum cast parts
- Small historical art and archeological objects
- Small geological samples

Maximize your uptime

What are your specific service requirements? We offer a wide range of service modules and packages tailored to your needs.

Our highly qualified global service team is committed to providing excellent service to our customers worldwide. With our eight global service centers and the specialized staff of our 50 service partners we always ensure a rapid response time wherever and whenever you need it. Your benefits include:

- High system availability
- Low inspection costs per part
- Best inspection quality
- Continuous operational safety

We align our organization and all service activities to comply with your requirements. With our innovative and modular service solutions you can count on true added value throughout the entire life cycle of your system.

We support you in limiting your CT inspection costs to a minimum. At the same time, your systems operate safely while obtaining optimum inspection results.

YXLON Life Cycle Service – more than the best image

- **Y.ServicePass** – increase your system availability
- **Y.WarrantyPass** – keep your costs predictable with an extended warranty
- **Y.SpareParts** – operate your system at peak performance with YXLON spares
- **Y.Updates** – keep your system state of the art
- **Y.Academy** – have your operators trained



Check out these facts and figures

| System principles | | Y.CT Precision | |
|-------------------|-----------------------|--|---|
| Inspection modes | | Cone-beam CT, Helical CT, Laminography | |
| Manipulation | | 7 axes, granite based | |
| X-ray components | | | |
| X-ray tube | | Detector | |
| | Y.FXE 225.48 | | YXLON XRD 1620 / XRD 1621 ¹⁾ |
| Maximum energy | 225 kV | Active area | 400 mm x 400 mm |
| Maximum power | ~ 320 W ²⁾ | Pixel pitch | 200 µm |
| Focal spot | ≤ 4 µm ³⁾ | Pixel matrix | 2048 x 2048 |
| TXI | yes ²⁾ | Frame rate | 3.75 fps - 7.5 fps / 15 fps - 30 fps |

1) Selected detectors acc. to specific YXLON pixel specification - ASTM E2597 compliant

2) TXI = True X-ray Indicator - controls real output dose for constant intensity

3) Acc. JIMA wire visibility at minimum focus size

| Inspection item | |
|---------------------------|-------------------|
| Maximum part size (Ø x h) | 600 mm x 1,250 mm |
| Turntable diameter | 300 mm |
| Maximum part weight | 50 kg |

| CT parameters | |
|--|-----------------------------|
| Focus Detector Distance (FDD) | range of 730 mm - 1,430 mm |
| Focus Object Distance (FOD) | range of 8.75 mm - 1,250 mm |
| Maximum magnification ⁴⁾ | > 163 |
| Minimum voxel size ⁵⁾ | down to 950 nm |
| CT field of view - standard (Ø x h, approx.) | 330 mm x 330 mm |
| CT field of view - extended (Ø x h, approx.) | 540 mm x 800 mm |

| Enclosure / System | |
|----------------------------|--------------------------------|
| Enclosure size (W x H x D) | 4,300 mm x 2,300 mm x 2,800 mm |
| CT system weight, approx. | 6,300 kg |
| Enclosure weight, approx. | 8,000 kg |

4) Calculated value assuming center of rotation 2 mm from x-ray tube surface

5) Determined by geometry and reconstruction parameters

Typical values are for standard system design and are approximate. Customization may affect these values. Other configurations on request.

Principle of cone-beam CT:
The 3D model comprises all information acquired by the detector during the rotation.

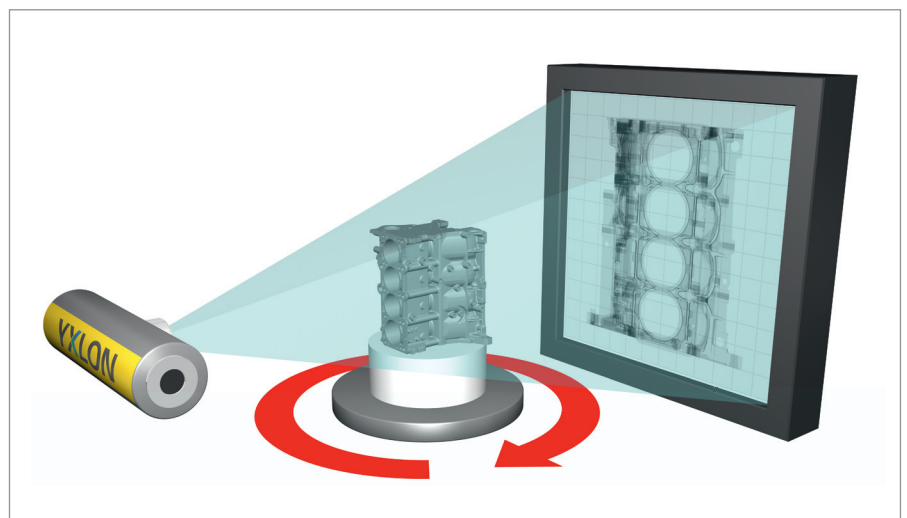

**Find the system
that suits you best**

| | Y.CT Compact | Y.CT Precision | Y.CT Modular |
|------------------------|--------------|----------------|--------------|
| Part size | + | ++ | +++ |
| Material density | ++ | + | +++ |
| Part weight | + | + | ++ |
| Detail visibility | ++ | +++ | +++ |
| 2D (digital radiology) | N/A | | |
| Laminography | N/A | | |
| Helical scan | N/A | | |

Would you like to learn more about our systems? Interested in a test inspection? Please contact us by phone or e-mail. We look forward to hearing from you.

YXLON

Technology with Passion

GERMANY – HEADQUARTERS

YXLON International GmbH

Essener Bogen 15
22419 Hamburg
Germany
T: +49 40 527 29-0

www.yxlon.com

CHINA

**YXLON
X-ray Equipment Trading Co., Ltd.**

1C1809 Web Time Center
Room A309, Building 2,
17 Zhongguancun South Ave.
Beijing 100081, P.R. China
T: +86 10 8857 9581
F: +86 10 8857 9580

USA

**YXLON Sales & Service Location
COMET Technologies USA Inc.**

5675 Hudson Industrial Parkway
Hudson, OH 44236
USA
T: +1 234-284-7849

JAPAN

YXLON International KK

New Stage Yokohama Bldg.,
1st Floor
1-1-32 Shinurashima-cho
Kanagawa-ku
Yokohama, 221-0031
Japan
T: +81 45 450 1730